

THE NETHERLANDS
(N E D E R L A N D)**COMMUNICATION**Concerning ⁽¹⁾:

- approval granted
- ~~approval extended~~
- ~~approval refused~~
- ~~approval withdrawn~~
- ~~production definitely discontinued~~

of a type of retro-reflecting device pursuant to Regulation number 3.

Approval number: E4-3R-0218756**Extension number: 00**

1. Trade name or mark of the device :
2. Manufacturer's name for the type of device :
3. Manufacturer's name and address :
4. If applicable, name and address of the manufacturer's representative :
5. Submitted for approval on : 21 October 2014
6. Technical service responsible for conducting approval tests : IDIADA Automotive Technology, S.A.
L'Albornar, P.O. Box 20
43710 Santa Oliva (Tarragona)
Spain
7. Date of test report : 27 October 2014
8. Number of test report : CN14100185
9. Concise description :

- In isolation/part of an assembly of devices⁽¹⁾ : part of an assembly of devices
- Colour of light emitted : ~~white~~/red/~~amber~~⁽¹⁾
- Installation as an integral part of a lamp which is integrated into the body of a vehicle : ~~yes~~/no⁽¹⁾
- Geometric conditions of installation and relating variations, if any : ---
10. Position of the approval mark : See annexed drawing
11. Reason(s) for extension (if applicable) : ---
12. Approval : ~~granted/refused/extended/withdrawn~~⁽¹⁾
13. Place : Zoetermeer
14. Date :
15. Signature :
16. The following documents, bearing the approval number shown above, are available on request:
—

⁽¹⁾ Strike out what does not apply.

1、 Specification data

Type						
Function		Rear position lamp	Stop lamp	Rear direction indicator	Rear registration plate lamp	Rear Retro-reflecting devices
Color		Red	Red	Amber	White	Red
Rated	Voltage	12V	12V	12V	12V	n/a
	Wattage	0.2w	0.4w	0.4w	0.2w	n/a
Application Regulation ECE		ECE R7.02	ECE R7.02	ECE R6.01	ECE R4.00	ECE R3.02
Location of marking	Filament lamp category	5*LED	5*LED	5*LED	5*LED	n/a
	Trade mark	Marked on housing				
		Marked on lens				
	Approval mark	Marked on lens				

2、 Construction and material

Construction	Material	Remarks
Lens	PMMA	Surface :Flat , no pattern Colour : white
Housing/ Reflector	ABS	Reflective coating: painting on the inside surface, Flat , no pattern, colour : Silvery.
Rear cover	ABS	--
Electrical Wiring	Copper covered with insulation	--

3、 Name and address of manufacturer :

4、 Name and address of representative of manufacturer : N/A

Note: This information folder consists of 7 pages

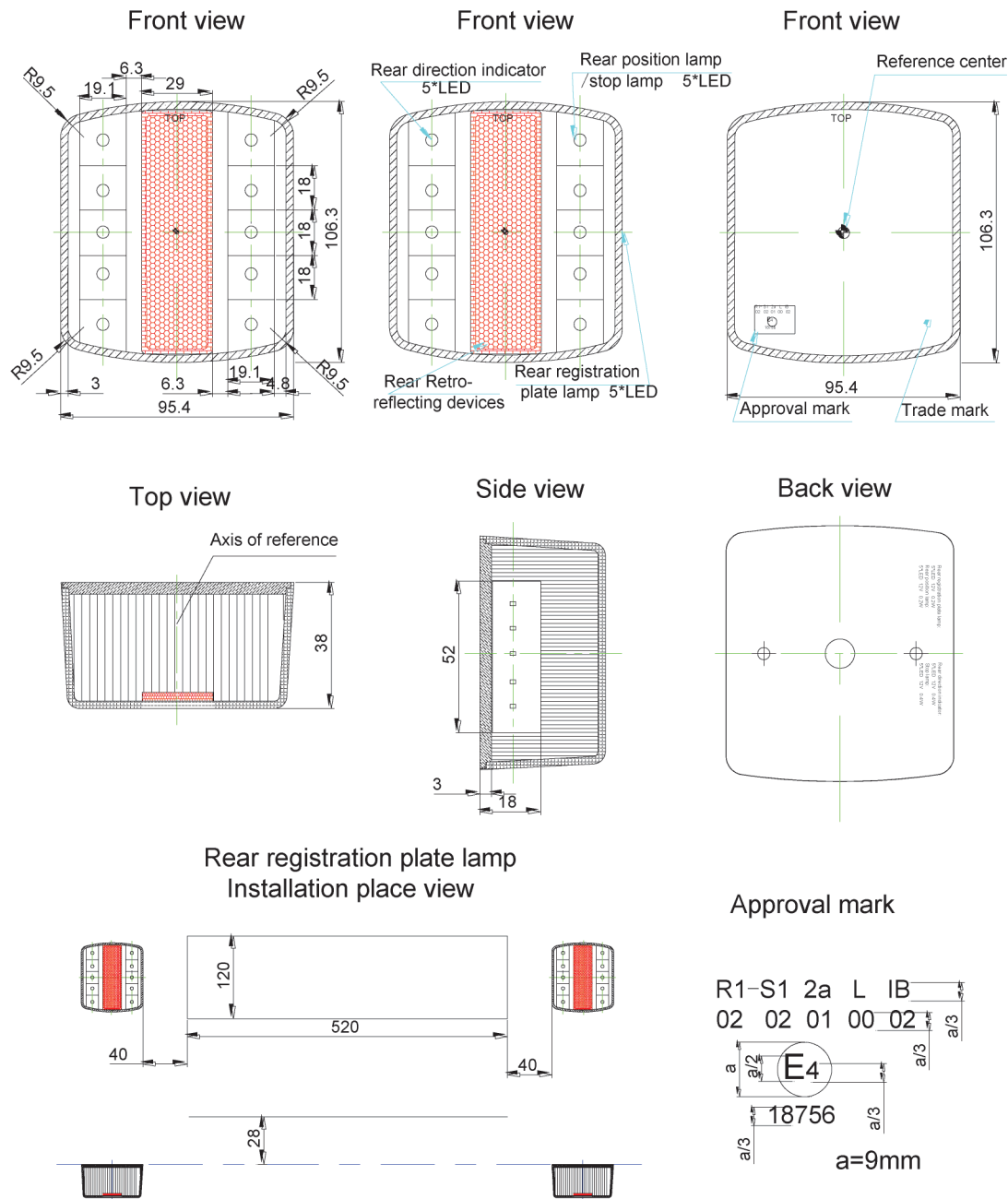

Assembly diagram

Product type	
Rear combined lamp	
Drawing No	001

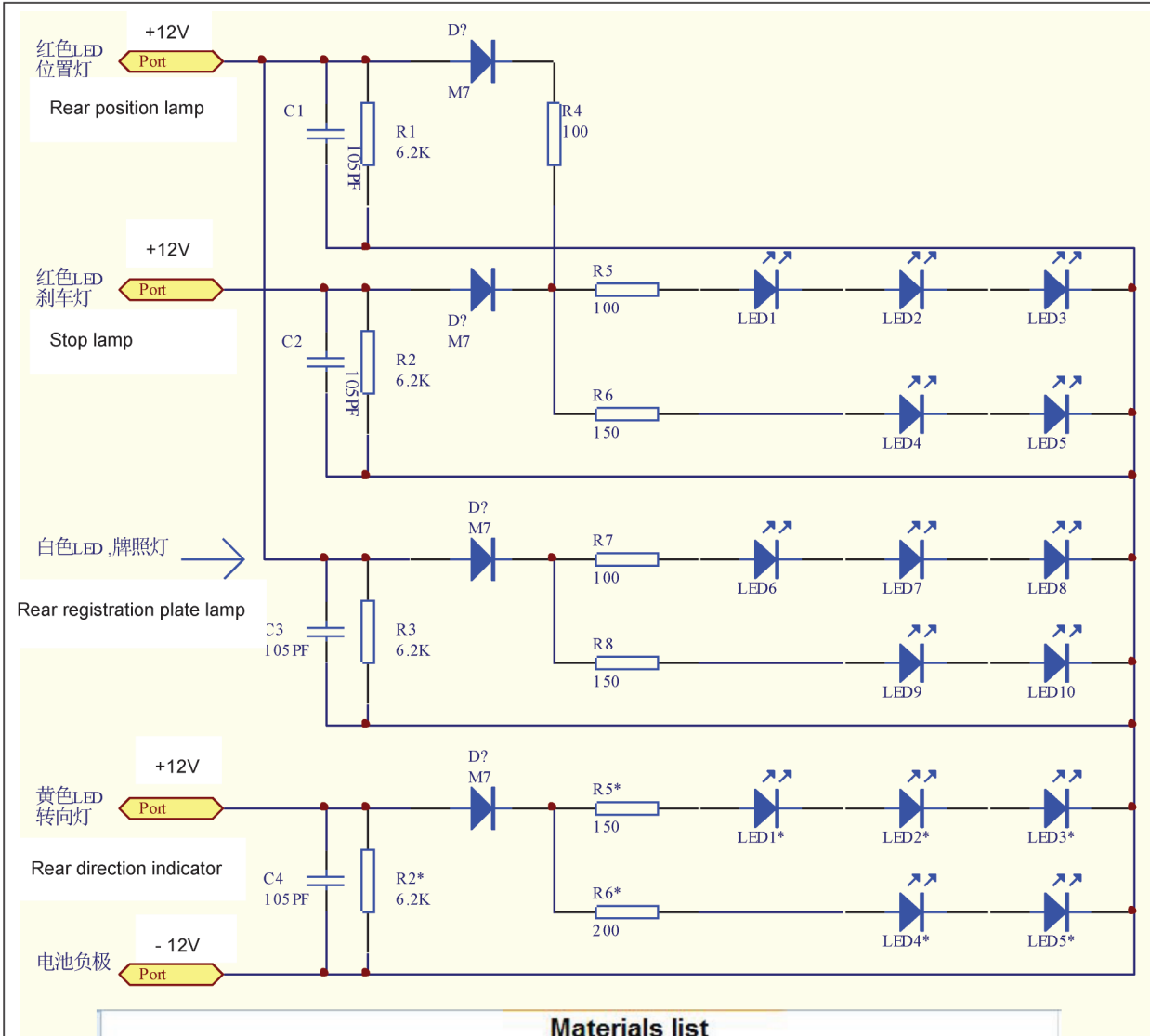

Materials list							
Product Type:							
No	Parts code	Parts name	Specifications type	Unit	Quantity	Loss rate%	Level
1	010501013	Triode	D2/M7	PCS	4	0	1
2	011301021	Self-tapping screws	white Stainless steel D2.8 PA 1.7*6	PCS	4	0	1
3	010250001	PCB	1527.V1	PCS	3	0	1
4	11RE060362K	0603 Resistance	YKD 0603 62K	PCS	4	0	1
5	11RE0603100R	0603 Resistance	YKD 0603 100R	PCS	3	0	1
6	11RE0603150R	0603 Resistance	YKD 0603 150R	PCS	3	0	1
7	11RE0603200R	0603 Resistance	YKD 0603 200R	PCS	1	0	1
8	012024131	LED	YKD 0120	PCS	15	0	1
9	010703015	Capacitance	0603 105P(105PF)	PCS	1	0	1

1/1

Circuit diagram

Product type	
Rear combined lamp	
Drawing No	002

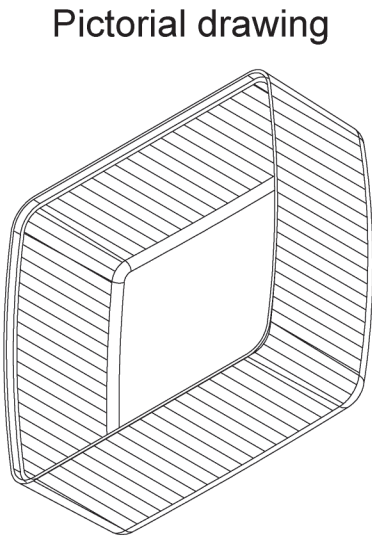
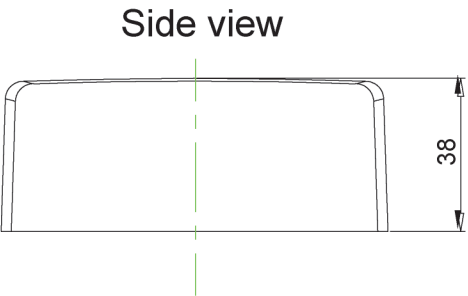
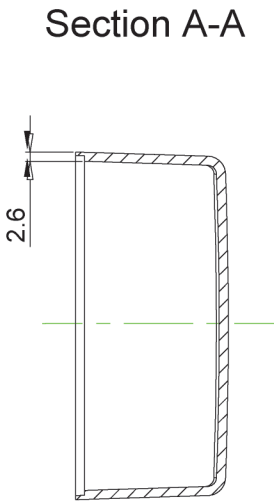
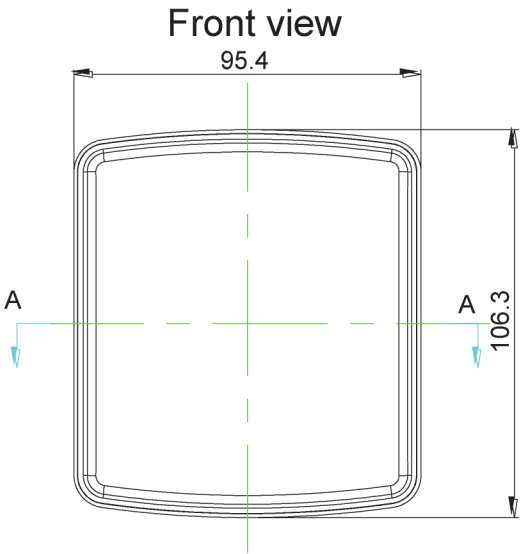

Lens

Product type	
Rear combined lamp	
Drawing No	002

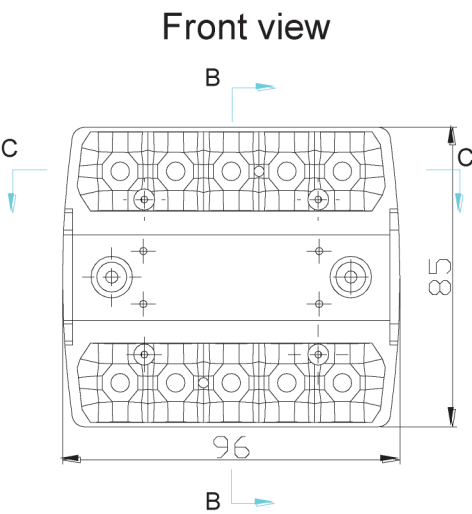

Section B-B

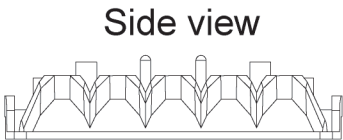
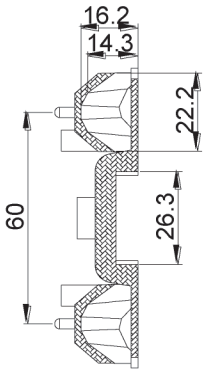

Pictorial drawing

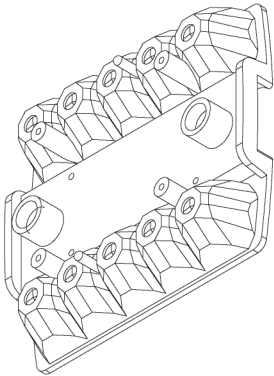

Section C-C

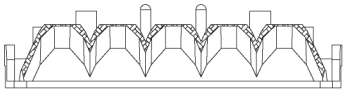

Housing / Reflector

Product type	
Rear combined lamp	
Drawing No	004

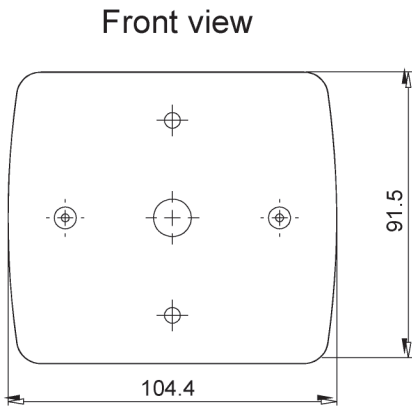

Top view

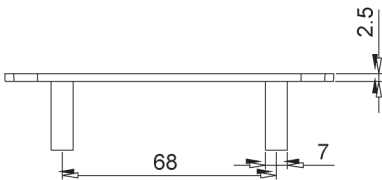

Side view

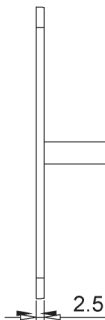

Pictorial drawing

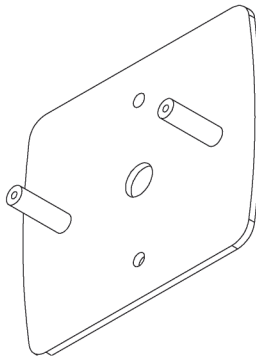

Rear cover

Product type	
Rear combined lamp	
Drawing No	005

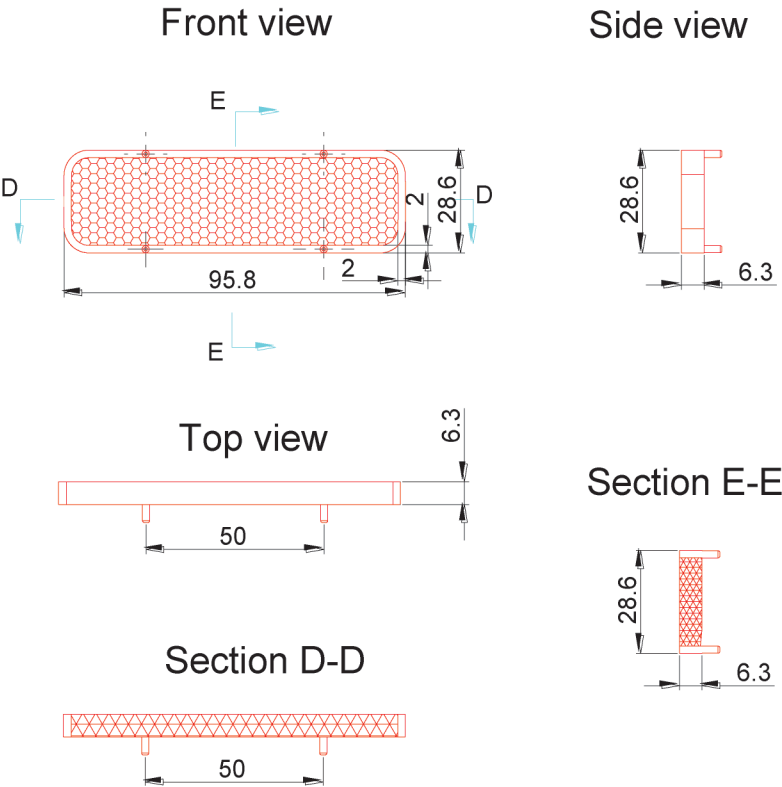

Rear Retro-reflecting devices

Product type	
Rear combined lamp	
Drawing No	006